

# BGC6 SERIES

## BGC6-220 6V AGM Deep Cycle Power



**BOSCH**

Invented for life

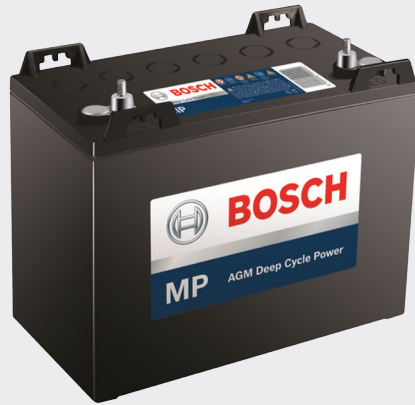

Image is generic & may vary to actual product

### Specifications

Short Order Number	BGC6-220	
Bosch 10 Digit Part Number	0092L57076	
Nominal Voltage	6V	
Dimension	Length	260mm (10.24 inches)
	Width	180mm (7.09 inches)
	Container Height	247mm (9.72 inches)
	Total Height (with Terminal)	253mm (9.96 inches)
Approx Weight	Approx 30.50 kg (67.30lbs)	
Terminal	T11	
Container Material	ABS	
Rated Capacity	240.0 AH/100hr	
	220.0 AH/20hr	
	205.0 AH/10hr	
	185.0 AH/5hr	
	160.0 AH/3hr	
Operating Temp.Range	Discharge:	-15~50°C (5~122°F)
	Charge:	0~40°C (32~104°F)
	Storage:	-15~40°C (5~104°F)

### Applications

- ▶ Golf carts or electric buggies
- ▶ Floor machines
- ▶ Electric recreational and utility vehicles

### Features and Benefits

- ▶ True deep cycle AGM technology
- ▶ Over 99.99% virgin lead for grid plate and active material
- ▶ Heavy duty grid/paste design for deep cycle application
- ▶ Maintenance free, non-spillable, valve-regulated
- ▶ Double separator configuration long cycle life & high energy density and super anti-vibration design
- ▶ Low self-discharge for longer shelf life

### Certification Standards



# Dimensions

## T11 Terminal Unit: mm

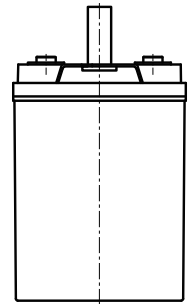
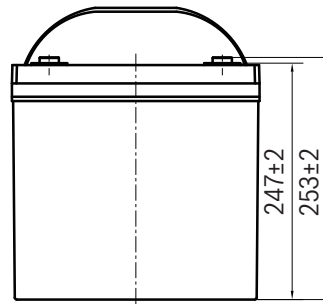
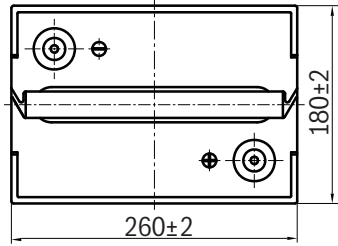
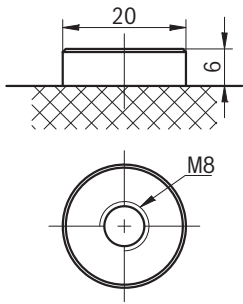

Note: Terminal Torque Values in-lb(Nm): 97.28-130.0(11-14.7)

# Product Performance Charts

## AGM Charging Profile

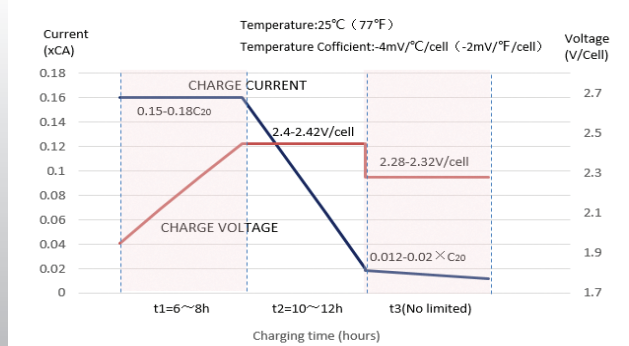

## Relationship of OCV and State Of Charge (25°C, 77°C)

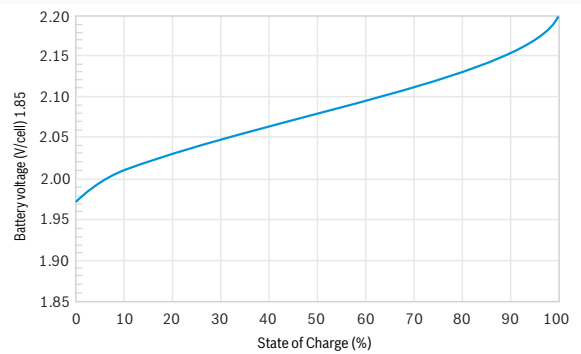

## Cycle Life in Relation to Depth of Discharge

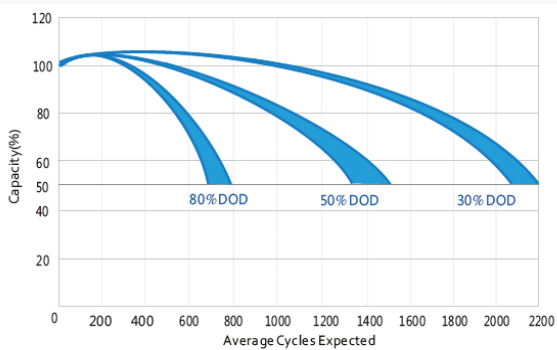

## Self-discharge Characteristic

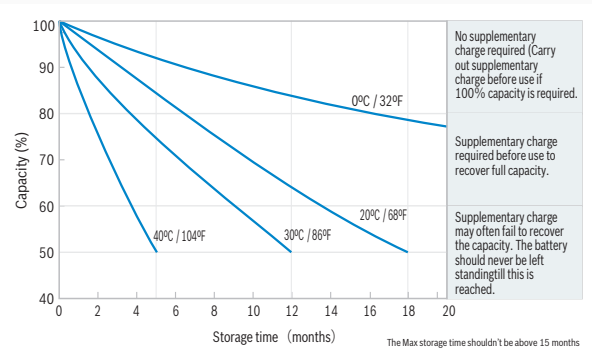

Your address for genuine Bosch quality:

**Dealer stamp here:**